

## How to use TAMOTSU

① Spread TAMOTSU in a case or tray.

The quantity of spread depends on the quantity you use within 1 hour.

② The effective time with leaving in the air is 1 hour. Please use TAMOTSU within 1 hour.

③ TAMOTSU in innerbag need to preserve from air by sealing the innerbag.

④ Put TAMOTSU with subjects in a package. If TAMOTSU is compressed by foods in the package, TAMOTSU can not touch air and absorb oxygen enough. Place to expose the air inside the package.

⑤ Please seal the package completely.

⑥ Fill TAMOTSU after using TAMOTSU spread in ①.

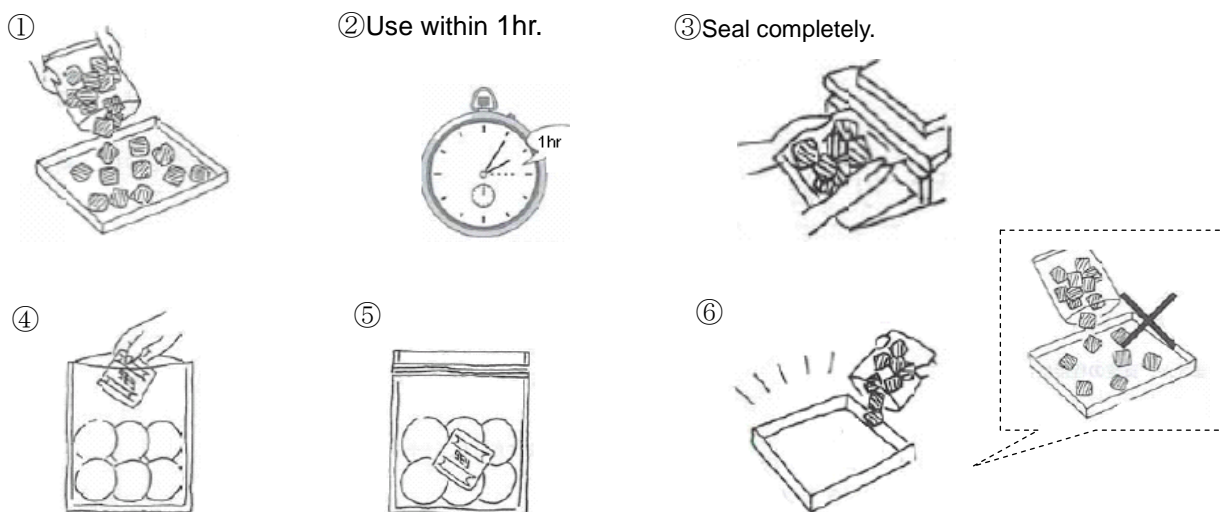

## Attention

Use if the wondersensor in innerbag is "Pink". If wondersensor is "Blue", please return without opening innerbag.

Do not use cutter when opening a box. (to avoid possibility of damage to pouch or innerbag.)

Do not leave TAMOTSU in innerbag opened.

Do not leave TAMOTSU more than 1 hour in the air.

Store TAMOTSU with cool and dark place. Keep away from direct sunlight.

Blue : Not effective.

Pink: Effective.

